

Date: 01/13/2020  
 Author: AL  
 Project: Prest Rd Widening  
 Work Activities: Clearing, Road Widening, Utility Locates, Culvert Installation  
 Comments: TCP shall follow latest MoTI TMM, OHSA and MVA regulations and requirements. Traffic Signs to follow MoTI Specs  
 Hours of Work: 7:00am to 5:00pm  
 Notes:  
 - Single Lane Alternating Traffic.  
 - Moving work zone. Only one closure is set up at any time.  
 - Maximum working area - 150 LM.  
 - Closure is to be set up on the opposite direction with same layout.  
 - TCP to assist vehicles access/exit driveways.

Legend:  
 ○ Delineator    Working Zone    Barricade

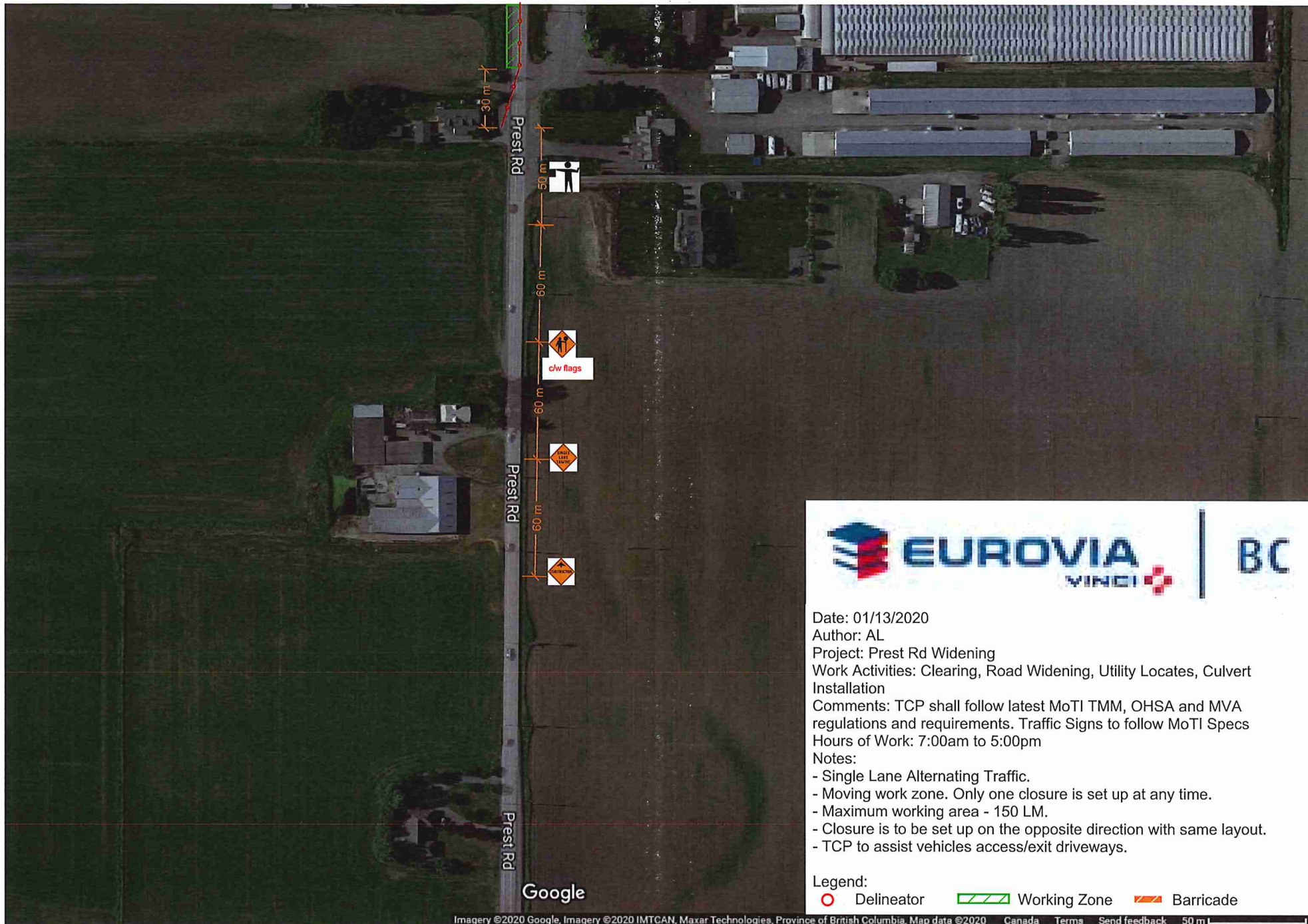

Date: 01/13/2020

Author: AL

Project: Prest Rd Widening

Work Activities: Clearing, Road Widening, Utility Locates, Culvert Installation

Comments: TCP shall follow latest MoTI TMM, OHSA and MVA regulations and requirements. Traffic Signs to follow MoTI Specs

Hours of Work: 7:00am to 5:00pm

Notes:

- Single Lane Alternating Traffic.
- Moving work zone. Only one closure is set up at any time.
- Maximum working area - 150 LM.
- Closure is to be set up on the opposite direction with same layout.
- TCP to assist vehicles access/exit driveways.

Legend:

○ Delineator     Working Zone     Barricade









Date: 01/13/2020

Author: AL

Project: Prest Rd Widening

Work Activities: Clearing, Road Widening, Utility Locates, Culvert Installation

Comments: TCP shall follow latest MoTI TMM, OHSA and MVA regulations and requirements. Traffic Signs to follow MoTI Specs  
Hours of Work: 7:00am to 5:00pm

Notes:

- Single Lane Alternating Traffic.
- Moving work zone. Only one closure is set up at any time.
- Maximum working area - 150 LM.
- Closure is to be set up on the opposite direction with same layout.
- TCP to assist vehicles access/exit driveways.

Legend:

○ Delineator     Working Zone     Barricade

Date: 01/13/2020

Author: AL

Project: Prest Rd Widening

Work Activities: Clearing, Road Widening, Utility Locates, Culvert Installation

Comments: TCP shall follow latest MoTI TMM, OHSA and MVA regulations and requirements. Traffic Signs to follow MoTI Specs  
Hours of Work: 7:00am to 5:00pm

Notes:

- Single Lane Alternating Traffic.
- Moving work zone. Only one closure is set up at any time.
- Maximum working area - 150 LM.
- Closure is to be set up on the opposite direction with same layout.
- TCP to assist vehicles access/exit driveways.

Legend:

 Delineator

 Working Zone

 Barricade

